

## big bang 4



Collectie spots waarbij de nadruk ligt op techniek en beweegbaarheid. Elk onderdeel heeft een welbepaalde functie waardoor de vormtaal als eerlijk en niet opdringerig overkomt. Daardoor integreert de BANG zich in alle mogelijke omgevingen en is zo makkelijk toepasbaar. Uitgevoerd in geborsteld aluminium toont de Bang zich in een industriële en karaktervolle gedaante. In de gelakte uitvoering wordt het accent verlegd naar de elegante, vloeiende lijnen. De Bang is verkrijgbaar voor 12V- of 230V-dicroïdelampen.

Collection de spots où l'accent est placé sur la technique et la mobilité. Chaque élément possède une fonction bien déterminée pour laquelle le langage des formes se révèle franc sans toutefois être envahissant. Le BANG s'intègre donc dans tous les environnements possibles et peut donc être utilisé facilement. Exécuté en aluminium brossé, le Bang adopte une forme industrielle et pleine de caractère. En version peinte, l'accent est alors placé sur les lignes élégantes et fluides. Le Bang est disponible pour des lampes dichroïques de 12V ou de 230V.

Spot collection with an emphasis on technique and mobility. Every part has a definite function, which provides for a candid and non-intrusive design. Because of this, BANG fits in any possible environment, which makes application easy. In brushed aluminium finish, Bang creates a bold 'industrial' impression. Then again, in enamel finish, its elegant fluent lines are emphasised. BANG is available for 12V or 230V dicroid lamps.

Bei diesen Kollektionsspoten stehen Technik und Beweglichkeit zentral. Jedes Teil hat eine bestimmte Funktion, wodurch die Formen ehrlich und nicht aufdringlich wirken. So passt BANG zu jeder Umgebung und ist die Leuchte leicht einsetzbar. Bang wurde aus gebürstetem Aluminium angefertigt und erhielt so ein industrielles, charaktervolles Aussehen. In der lackierten Ausführung stehen elegante, fließende Linien im Vordergrund. Bang ist mit dikroitischen 12-V- oder 230-V-Lampen erhältlich.

### big bang 4 AR111 base H15 mm

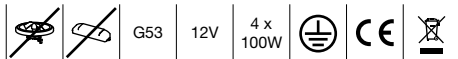

brushed aluminium  
grey painted  
white painted  
black painted

**T41C2HAB**  
**T41C2HGL**  
**T41C2HWL**  
**T41C2HZL**

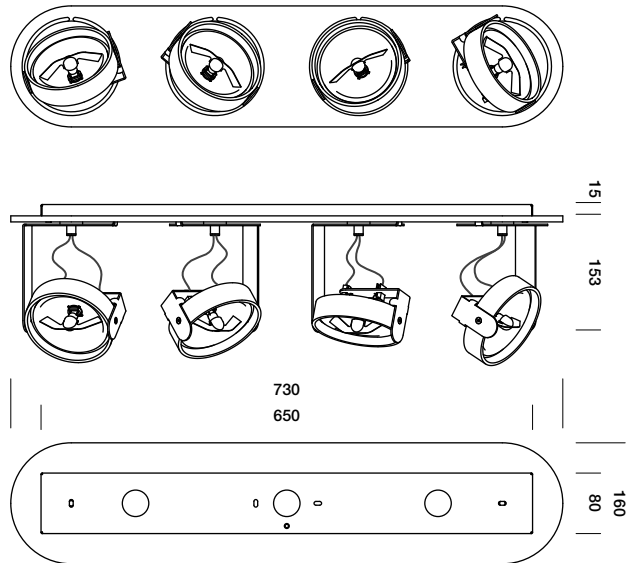

### big bang 4 AR111 base H40 mm

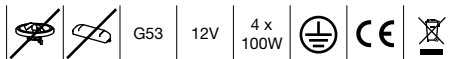

brushed aluminium  
grey painted  
white painted  
black painted

**T41C3HAB**  
**T41C3HGL**  
**T41C3HWL**  
**T41C3HZL**

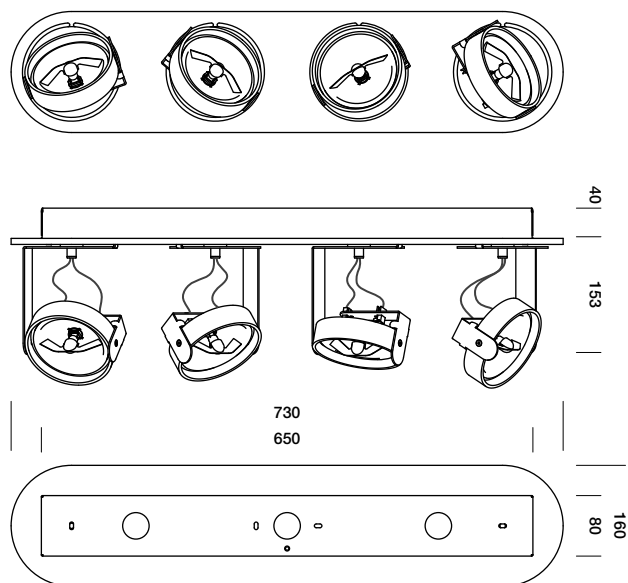

karveelstraat 2  
8380 zeebrugge, belgium

**T** +32 (0)50 54 35 49  
**F** +32 (0)50 54 35 40

**E** info@tossb.com  
**W** www.tossb.com

tossB reserves the right to alter materials, dimensions and characteristics without prior notice. This documentation replaces all previous documentation. Read the installation-instructions carefully.

Our general terms and conditions shall apply notwithstanding any stipulation to the contrary to all the orders and agreements with tossB. You can obtain a copy of these conditions on demand.

Product documentation © tossB 2011. All rights reserved.

### big bang 4 CDMR111

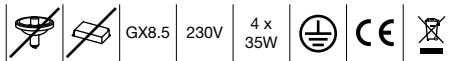

brushed aluminium  
grey painted  
white painted  
black painted

**T41C4OAB**  
**T41C4OGL**  
**T41C4OWL**  
**T41C4OZL**

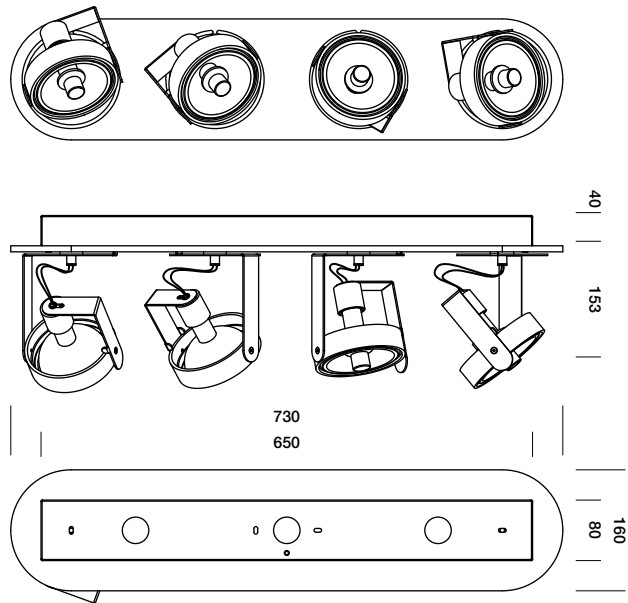

### big bang 4 CDMR111

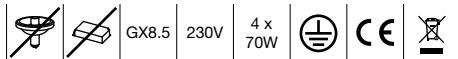

brushed aluminium  
grey painted  
white painted  
black painted

**T41C5OAB**  
**T41C5OGL**  
**T41C5OWL**  
**T41C5OZL**

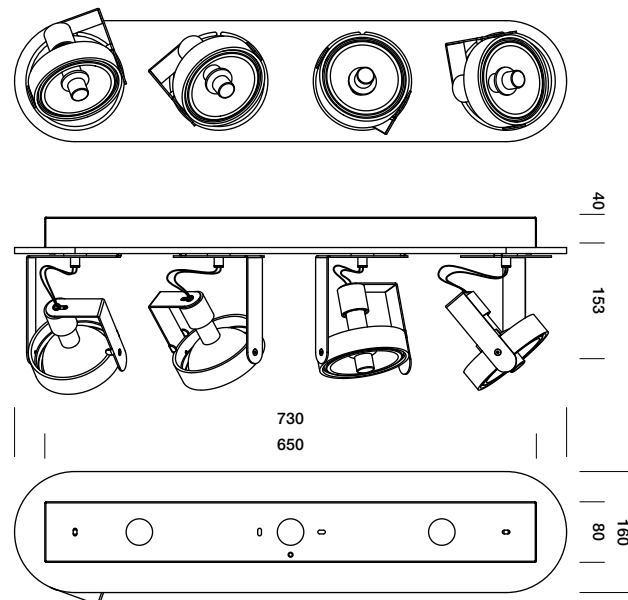

karveelstraat 2  
8380 zeebrugge, belgium

**T** +32 (0)50 54 35 49  
**F** +32 (0)50 54 35 40

**E** info@tossb.com  
**W** www.tossb.com

tossB reserves the right to alter materials, dimensions and characteristics without prior notice. This documentation replaces all previous documentation. Read the installation-instructions carefully.

Our general terms and conditions shall apply notwithstanding any stipulation to the contrary to all the orders and agreements with tossB. You can obtain a copy of these conditions on demand.

Product documentation © tossB 2011. All rights reserved.

## big bang 4 ES111

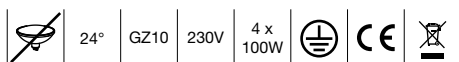

brushed aluminium  
grey painted  
white painted  
black painted

**T41C1HAB**  
**T41C1HGL**  
**T41C1HWL**  
**T41C1HZL**

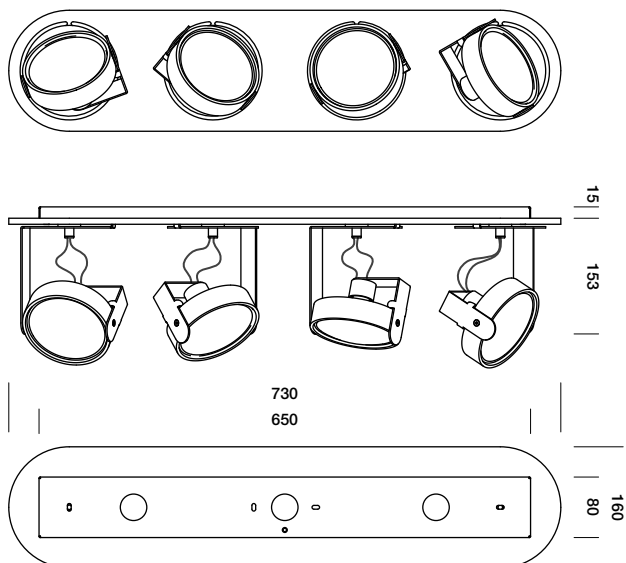

karveelstraat 2  
8380 zeebrugge, belgium

**T** +32 (0)50 54 35 49  
**F** +32 (0)50 54 35 40

**E** [info@tossb.com](mailto:info@tossb.com)  
**W** [www.tossb.com](http://www.tossb.com)

tossB reserves the right to alter materials, dimensions and characteristics without prior notice. This documentation replaces all previous documentation. Read the installation-instructions carefully.

Our general terms and conditions shall apply notwithstanding any stipulation to the contrary to all the orders and agreements with tossB. You can obtain a copy of these conditions on demand.

Product documentation © tossB 2012. All rights reserved.